

FILED

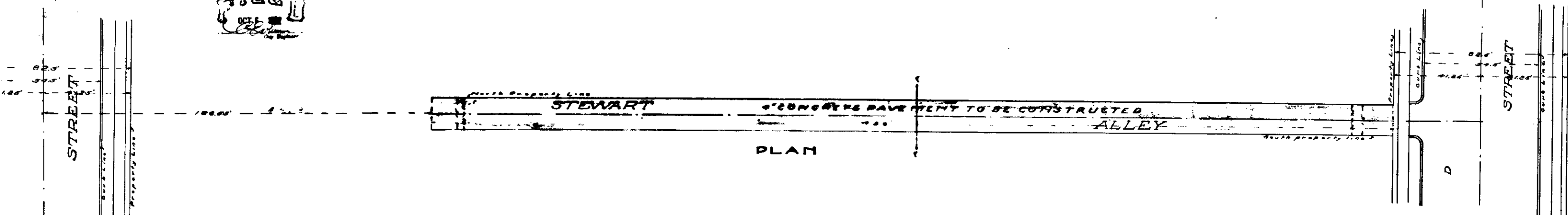

PLAN

PLAN No 492
 FOR THE IMPROVEMENT OF
STEWART ALLEY
 FROM THE WEST LINE OF D STREET
 TO A POINT 456 FEET WEST OF THE WEST LINE OF D STREET
 CITY OF SAN BERNARDINO
 Oct 5 1908

G. E. JOHNSON
 City Engineer

LEGEND

- means center line
- - - - - means foot-cast
- means street
- means alley
- means concrete pavement to be constructed
- means concrete pavement in place
- means center line of street

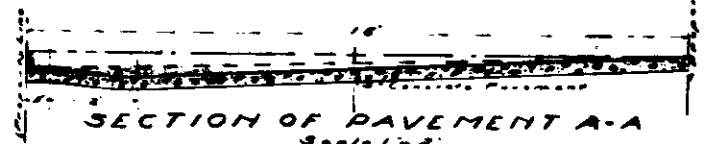

SECTION OF PAVEMENT A-A

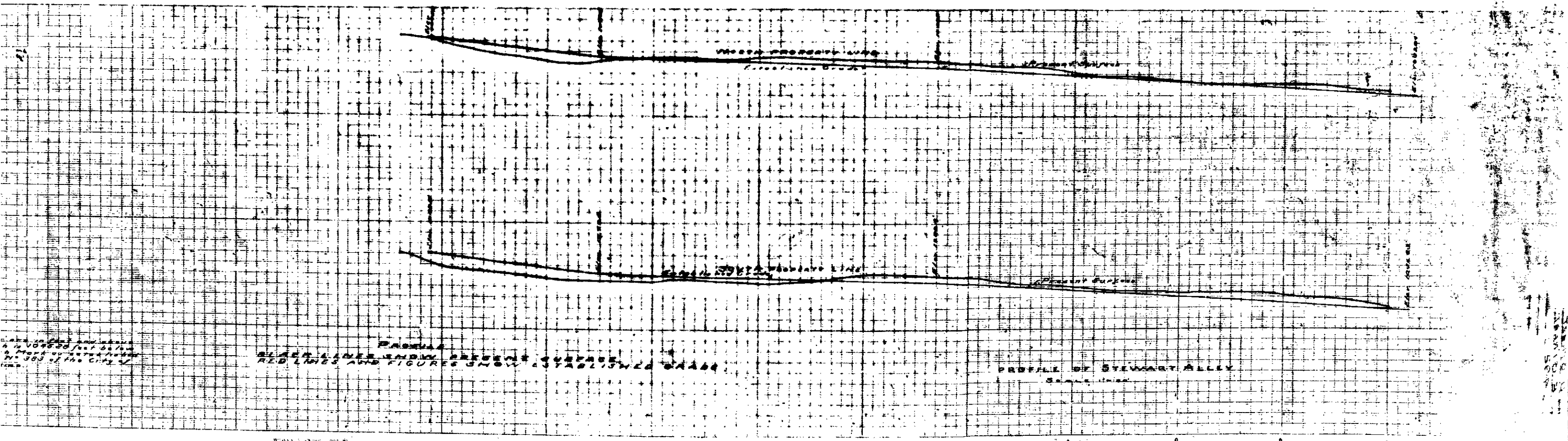

BLACK LINES SHOW PRESENT SURFACE
 RED LINES AND FIGURES SHOW ESTABLISHED GRADE

PROFILE OF STEWART ALLEY

Scale in feet and inches
 1" = 100' 0" feet
 1" = 10' 0" feet
 No. 965 of the City of